WEXFORD COUNTY ROAD COMMISSION

OUR MISSION IS TO IMPROVE AND MAINTAIN A SAFE AND EFFICIENT ROAD SYSTEM

June 10, 2021

NOTICE TO BIDDERS

Sealed bids will be received at the office of the Wexford County Road Commission, 85 West Highway M-115, Boon, Michigan 49618 until 3 p.m. Monday, June 28, 2021, at which time and place the bids will be opened and read for furnishing the Wexford County Road Commission for:

WCRC 2021 N 9 Road Crushing and Shaping

Specifications can be obtained at the above address or by visiting www.wexfordcrc.org

All bids must be submitted in a sealed envelope bearing the name of bidder, item being bid, and clearly marked as a sealed bid.

The Wexford County Road Commission, in accordance with Title VI of the Civil Rights Act of 1964, 78 Stat. 252, 42 USC 2000d to 2000d-4 and Title 49, Code of Federal Regulations, Department of Federally-assisted programs of the Department of Transportation issued pursuant to such Act, hereby notifies all bidders that it will affirmatively insure that in any contract entered into pursuant to this advertisement, minority business enterprises will be afforded full opportunity to submit bids in response to this invitation and will not be discriminated against on the grounds of gender, disability, race, color, or national origin in consideration for an award.

All work will be in accordance with the 2012 MDOT Standard Specifications for Construction. Insurance requirements shall be in accordance with the 2012 MDOT Standard Specifications for Construction.

The Board reserves the right to reject any or all bids, waive any defects, and to accept the bid which, in its opinion, is the most advantageous to the Road Commission.

Wexford County Road Commission

Harry Hagstrom, Chairman
Harold Falan, Vice- Chairman
Lorne Haase, Member
Dean Jurik, Member
Jim Leggett, Member

**Wexford County Road Commission
Bid Forms and Requirements for 2021
N 9 Road HMA Crushing and Shaping**

Page 1 of 4

**SEALED PROPOSALS (BIDS) WILL BE RECEIVED UNTIL 3:00 PM, EDT,
MONDAY, June 28, 2021**

Board of County Road Commissioners of the County of Wexford, 85 W. M-115
Boon, Michigan 49618.

BID REQUIREMENTS:

SIR: The undersigned has examined the location(s) of the work described herein and is fully informed as to the nature of the work and conditions relating to its performance and understands the quantities shown are approximate and are subject to either increase or decrease.

The undersigned hereby proposes to furnish all necessary equipment, tools, apparatus, and other means of construction, do all of the work, furnish all materials except as otherwise specified herein; and, for the unit prices named in the **attached Itemized Bid Form**, to complete the work herein described in strict accordance with the plans and the requirements of these bid documents.

The undersigned further proposes to perform extra work (for items that are not included with the itemized form) that may be authorized by the Wexford County Road Commission (WCRC). Compensation for extra work will be made on the basis of an agreed upon unit price prior to performing the extra work.

SPECIFICATIONS AND PLANS:

All materials, equipment, and construction methods used on the project(s) shall be in accordance with the applicable sections of the Michigan Department of Transportation (MDOT) 2012 Standard Specifications for Construction, MDOT supplemental specifications, and the attached plans, special provisions, and other bid documents.

PROGRESS SCHEDULE:

WCRC anticipates that construction can begin no earlier than **August 25, 2021**. In no case shall any work be commenced prior to receiving notice of award of contract from MCRC.

The Contractor must submit a complete, detailed and signed MDOT Form 1130, Progress Schedule, to the Engineer within seven (7) calendar days after award and prior to starting work. The Progress Schedule must include, as a minimum, the controlling work items for the completion of the project, as well as the planned dates or work days that these work items will be the controlling operations.

**Wexford County Road Commission
Bid Forms and Requirements for 2021
N 9 Road HMA Crushing and Shaping**

Page 2 of 4

The entire project must be completed on or before the final project completion date of **October 9, 2021**. Failure to complete all pay items by the completion date will result in the Contractor being assessed Liquidated Damages in accordance with Section 108.10 of the 2012 Standard Specifications for Construction.

Work delays due to “Labor disputes” as shown in Section 108.08.C.6 of the MDOT 2012 Standard Specifications for Construction will not be considered as an “excusable delay without liquidated damages” in the granting of time extensions to the completion date for the project. The Contractor will be assessed Liquidated Damages in accordance with Section 108.10 of the MDOT 2012 Standard Specifications should the project work be delayed due to a labor dispute.

After award and prior to the start of the work, the Contractor must attend a preconstruction meeting with the Engineer and the Owner (Wexford County Road Commission) at the WCRC. The Engineer will arrange the day and time for the meeting.

BID GUARANTEES:

The undersigned enclosed a certified or cashier’s check on an open solvent bank, or bid bond, in the amount of not less than \$2,000.00 payable to the Wexford County Board of Road Commissioners as a guarantee of good faith. If the undersigned is the successful bidder, and fails to enter into a contract or to furnish satisfactory bonds to the Board of Wexford County Road Commissioners within fifteen (15) days after being furnished with the necessary contract and bond forms, said check, or bid bond, shall be forfeited to the Board of County Road Commissioners as liquidated damages. It is understood that the check, or bid bond, of the selected bidder will not be returned until the contract has been executed, and that the proposal guarantees of all except the selected bidder, will be returned promptly.

This bid guarantee will cover all projects shown in these bid documents.

INSURANCE REQUIREMENTS:

The successful bidder shall furnish proof of standard Owner’s Protective Liability and Owner’s Protective Property Damage Liability Insurance within ten days upon notification of award of the Contract and prior to beginning work on the project(s). The following minimum requirements must be included on the certificate of insurance:

**Wexford County Road Commission
Bid Forms and Requirements for 2021
N 9 Road HMA Crushing and Shaping**

Page 3 of 4

Bodily Injury or Death Liability:
Each Person.....\$500,000
Each Occurrence.....\$1,000,000
Aggregate.....\$2,000,000

Property Damage and Physical Damage to Property Liability:
Each Occurrence.....\$1,000,000
Aggregate.....\$2,000,000

The permittee or contractor shall name the WCRC as additional insured, by name on the certificate of insurance worded as follows:

“The Board of Wexford County Road Commissioners, the Wexford County Road Commission, and their officers, agents, and employees, are named as additional insured parties.”

The policy shall state that the WCRC must be given thirty (30) days written notice before said insurance is altered or cancelled.

DELAYED ACCEPTANCE, FINAL INSPECTION, AND PAYMENT TO CONTRACTOR:

The WCRC Manager and/or Construction Supervisor (or designated representatives) will inspect the project with the Contractor after all work is completed, a minimum of one (1) week prior to the final project completion date. If deficiencies are found, corrective work is required. Complete all corrective work by the final project completion date, or by an agreed upon date. All costs associated with completing this corrective work, to the satisfaction of the WCRC, will be borne by the Contractor.

The WCRC will not pay the Contractor for the work performed on the projects until after the inspections are completed, corrective work is completed (if necessary), and the projects are accepted by the WCRC.

PROJECT QUANTITIES AND INVOICING REQUIREMENTS

The Contractor shall document and record the “As-built” quantities for the pay items for the project as the work is being performed.

The Contractor shall provide load tickets for materials placed (HMA, aggregate, etc.) on the project to the WCRC and/or their representatives.

“As-built” quantities will be verified by the WCRC and/or their representatives.

**Wexford County Road Commission
Bid Forms and Requirements for 2021
N 9 Road HMA Crushing and Shaping**

Page 4 of 4

It is important for the Contractor to provide accurate documentation and invoices to the WCRC for review, consideration, and processing.

MEASUREMENT AND PAYMENT:

The completed work, including all materials, labor, and equipment, as measured, will be paid for at the contract unit price for the items (pay items), as shown on the Itemized Bid Form.

COMPANY NAME: _____

COMPANY ADDRESS: _____

PHONE: _____ FAX: _____

EMAIL: _____

BIDDERS NAME AND TITLE: _____

BIDDERS SIGNATURE: _____

DATE: _____

The Board reserves the right to accept or reject any or all bids and to accept the bids it feels is in the best interest of the Wexford County Road Commission.

Date: 06/10/2021

PROGRESS CLAUSE: The Contractor shall prepare and submit a complete, detailed and signed MDOT Form 1130, Progress Schedule according to 12SP-101A.

The Progress Schedule must include, as a minimum, the controlling work items for the completion of the project, as well as the planned dates or work days that these work items will be the controlling operations. All contract dates, including open to traffic, project completion, interim completion and any other controlling dates in the contract, must be included in the progress schedule.

If the bidding Proposal specifies other controlling dates, these shall also be included in the Progress Schedule.

After receiving Notice of Award, start work on the date approved by the Engineer, which date must be no earlier than **August 25, 2021**. In no case, may any work be commenced prior to receipt of formal notice of award by the Department.

From August 25, 2021 through September 3, 2021:

- Work shall be performed on the northerly 1 mile (between 4 Road & the POE).
- By the end of the Monday workday (August 30), roadway mainline work shall be completed, including trenching, aggregate base and crushing and shaping, and ready for HMA paving (by others).
 - By the end of the Wednesday workday (September 1), 2" of HMA leveling course, by others, will be placed.
 - By the end of the Friday workday (September 3), complete Shoulder, Class III work.
 - Within 1 week of placement of the 2" HMA leveling course, complete approach road/driveway contract items. Approach road/driveway HMA paving (by others) shall be completed immediately after.

From September 7, 2021 through September 30, 2021:

- Work will be permitted on the entire project length.
- Each week, by the end of the Thursday workday, roadway mainline work shall be completed, including trenching, aggregate base and crushing and shaping, and ready for HMA paving (by others).
 - By the end of the following Monday workday, 2" of HMA leveling course, by others, will be placed.
 - Within 1 week of placement of the 2" HMA leveling course, complete Shoulder, Class III and approach road/driveway contract items. Approach road/driveway HMA paving (by others) shall be completed immediately after.

PROGRESS CLAUSE CONTINUED:

To meet the above requirements and allow for weekly HMA paving, it is anticipated that the 7.31 mile project length shall be completed as follows:

Segment Limits	End of workday for mainline ready for HMA paving
POE south to 4 Road (1 mile +/-)	8-30-21
4 Road south to 6 Road (1 mile +/-)	9-9-21
6 Road south to 10 Road (2 miles +/-)	9-16-21
10 Road south to 14 Road (2 miles +/-)	9-23-21
14 Road south to the POB (1.31 miles +/-)	9-30-21

All contract work must be completed on or before the final project completion date of **October 9, 2021**.

After award and prior to the start of work, the Contractor must attend a preconstruction meeting with the Engineer. The Engineer will determine the day, time and place for the preconstruction meeting. The meeting will be conducted after project award and may be rescheduled if there are delays in the award of the project. The named subcontractor(s) for, Designated and/or Specialty Items, as shown in the proposal, should attend the preconstruction meeting if such items materially affect the work schedule.

Liquidated Damages shall be assessed in accordance with Section 108.10 of the 2012 Standard Specifications for Construction.

The Contractor may be required to meet with Department representatives for a post-construction review meeting, as directed by the Engineer. The Engineer will schedule the meeting.

Failure on the part of the Contractor to carry out the provisions of this Progress Clause may be considered sufficient cause to prevent bidding future projects.

COORDINATION CLAUSE

KPM/PJM

Page 1 of 1

6/9/2021

The contractor is advised that other projects in the vicinity may be under construction during the life of this contract, including, but not limited to:

MDOT Let JN 132042: Bridge superstructure replacement, substructure repair and approach reconstruction on M-115 over the Manistee River.

WCRC Local Paving Project: 9 Road from M-115 northerly to 2 Road (County Line Road). Includes 2 inches of HMA, 4E1, leveling course.

MDOT Let JN 211956: 9 Road from M-115 northerly to 2 Road (County Line Road). Includes 2 inches of HMA, 4E1, top course, aggregate shoulders and permanent pavement markings.

The contractor is reminded of the requirements in Section 104.08 of the 2012 Standard Specifications to cooperate with other contractors, utility companies, and public agencies.

**WEXFORD COUNTY ROAD COMMISSION
SPECIAL PROVISION
FOR
MAINTAINING TRAFFIC**

KPM:PJM

1 of 3

6/9/2021

A. General. Traffic will be maintained in accordance with the 2012 Standard Specifications for Construction, including any supplemental specifications, and as herein specified. All traffic control devices and their usage shall comply with the 2011 edition of the Michigan Manual of Uniform Traffic Control Devices (MMUTCD).

The Wexford County Road Commission (WCRC) may perform maintenance work within or adjacent to the Construction Influence Area (CIA). WCRC will coordinate their operations to minimize the interference to the Contractor. No additional payment will be made to the Contractor for the joint use of the traffic control items.

B. Construction Influence Area (CIA):

The CIA limits shall include the area within the right-of-way for 9 Road from M-115 northerly to 2 Road (County Line Road). The CIA shall also extend a distance in advance of the project limits as required for the advanced construction signing and traffic control devices. The CIA shall extend down all intersecting roadways a distance of 550 feet. The CIA shall also include detour route.

C. Traffic Restrictions:

Conduct all work between sunrise and sunset local time. "Work" is defined as any activity on the project, including set up and take down of traffic control devices. No work shall be permitted on Sundays, holidays, or during special events as defined by the Engineer. Holiday periods are defined as:

Labor Day - 3:00 pm, Friday, 09/03/21 to 6:00 am, Tuesday, 09/07/21

Prior to September 6, 2021, 9 Road traffic, from 4 Road northerly, shall be maintained with traf regulator control in accordance with Maintaining Traffic Typical M0020a and M0150a. A speed reduction will be used. The work zone speed limit will be 45 miles per hour.

After September 6, 2021, all of 9 Road will be closed to through traffic in accordance with the detour signing plan. Detour signing shall not be placed until MDOT's detour signing for JN 132042 (Bridge superstructure replacement project on M-115 over Manistee River) has been removed; anticipated to be by September 7, 2021. Local traffic shall be maintained at all times.

Commercial and residential driveways shall remain accessible at all times.

D. Traffic Control Devices:

All warning signs shall be 48" x 48" mounted at 5 ft minimum bottom height in uncurbed areas and 7 ft minimum bottom height in curbed or pedestrian areas. All construction signs left in place for a duration exceeding 14 days will be on driven posts as per WZD-100-A. Temporary Traffic Control Devices shall conform to WZD-125-E.

Quantities for traffic control devices have been estimated based on one sequence of Maintaining Traffic Typical M0150a, the detour, plus fifteen (15) W20-3 "Road Closed Ahead" signs to be placed on intersecting roads.

E. Measurement and Payment. Payment for traffic control devices will be based on the maximum square feet of the signs in place at any one time. The square feet of all non-standard specially fabricated signs and all signs used at a different time uncommon to the sequences used in determining the maximum square feet will also be paid for separately. Payment will be in accordance with section 812.04 of the 2012 Standard Specifications for the following contract items (pay items).

<u>Contract Item</u>	<u>Pay Unit</u>
Traffic Control.....	Lump Sum

Estimates of Maintaining Traffic Quantities

Barricade, Type III, High Intensity, Double Sided, Lighted, Furn	6 Each
Barricade, Type III, High Intensity, Double Sided, Lighted, Oper	6 Each
Sign, Type B, Temp, Prismatic Furn	697 Square Foot
Sign, Type B, Temp, Prismatic Oper	697 Square Foot
Sign, Type B, Temp, Prismatic, Spec, Furn.....	43 Square Foot
Sign, Type B, Temp, Prismatic, Spec Oper	43 Square Foot
Minor Traf Devices	1 Lump Sum
Lighted Arrow, Type C, Furn.....	2 Each
Lighted Arrow, Type C, Oper.....	2 Each
Traf Regulator Control.....	1 Lump Sum

Estimated quantities for the items above are provided for information only. They shall be included in the lump sum pay item for Traffic Control.

ROAD CLOSURE/DETOUR SIGNING PLAN

9 ROAD

ROAD CLOSURE OF 9 ROAD, BETWEEN M-115 & 2 ROAD

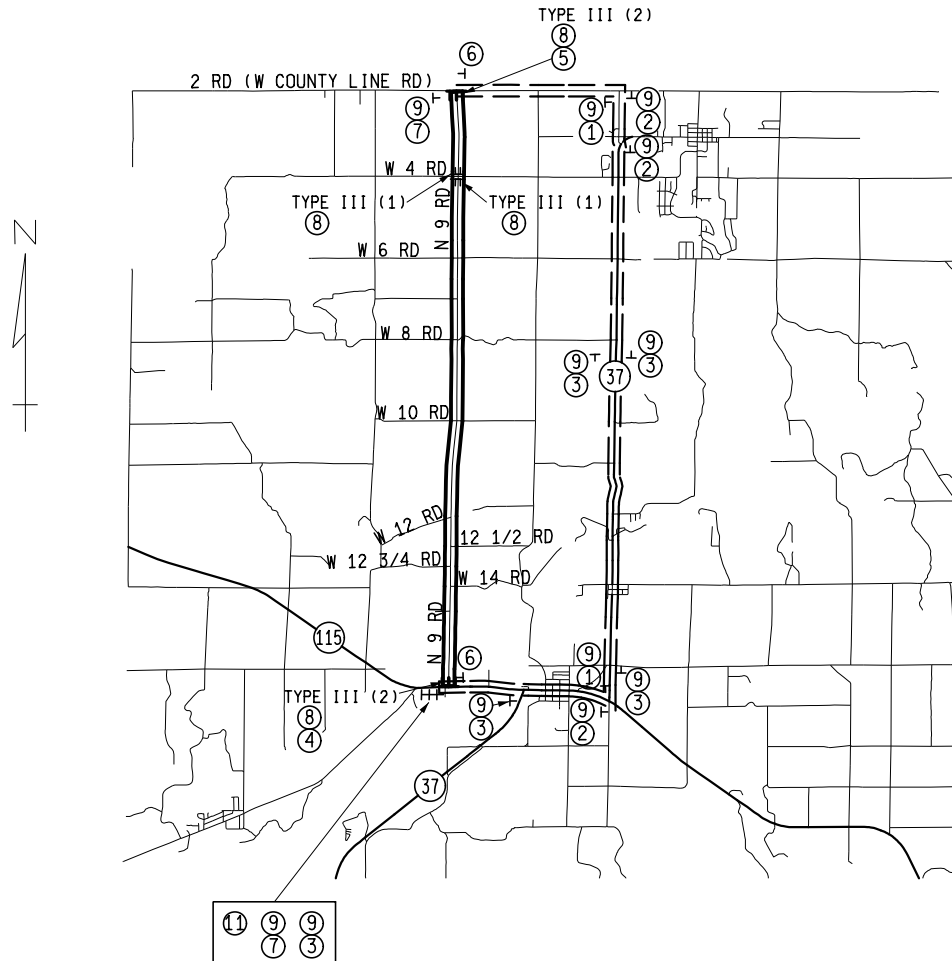

MMUTCD DESIGN	LEGEND	QUANTITY	SIZE
①	M4-9(RT) DETOUR RIGHT	2	30" x 24"
②	M4-9(LT) DETOUR LEFT	3	30" x 24"
③	M4-9(ST) DETOUR STRAIGHT	4	30" x 24"
④	M4-10(RT) DETOUR RIGHT	1	48" x 18"
⑤	M4-10(LT) DETOUR LEFT	1	48" x 18"
⑥	M4-8a END DETOUR	2	24" x 18"
⑦	W20-2 DETOUR AHEAD	2	48" x 48"
⑧	R11-4 ROAD CLOSED TO THRU TRAFFIC	4	60" x 30"
⑨	D3-VAR 1 9 ROAD	12	30" x 12"
⑩	W20-3 ROAD CLOSED AHEAD	0	48" x 48"
⑪	R11-VAR 1 9 ROAD CLOSED NORTH OF M-115	1	60" x 30"
	BARRICADE, TYPE III, HIGH INTENSITY, DOUBLE SIDED, LIGHTED	6	

9 ROAD

⑨

D3-VAR1
30" X 12"
4" "C" LETTERS
BLACK ON ORANGE

9 RD
CLOSED
NORTH OF M-115

⑪

R11-VAR1
60" x 30"
4" "C" LETTERS
BLACK ON ORANGE

NO SCALE



3 WORKING DAYS
BEFORE YOU DIG
CALL MISS DIG
800-482-7171
OR 811

KPM ENGINEERING
CIVIL ENGINEERING CONSULTANTS

9 ROAD
SPRINGVILLE & WEXFORD TOWNSHIPS

DATE: 6/9/2021

WEXFORD COUNTY
ROAD COMMISSION
85 WEST HIGHWAY M-115
BOON, MI 49618

DRAWN BY
PJM

SHEET NO.

WEXFORD COUNTY ROAD COMMISSION

**NOTICE TO BIDDERS
UTILITY COORDINATION**

KPM:PJM

Page 1 of 1

6-9-2021
9 Road

The contractor shall cooperate and coordinate construction activities with the owners of utilities as stated in Section 104.08 of the 2012 MDOT Standard Specifications for Construction. In addition, for the protection of underground utilities, the contractor shall follow the requirements in Section 107.12 of the 2012 MDOT Standard Specifications for Construction. Contractor delay claims, resulting from a utility, will be determined based upon Section 108.09 and 109.05 of the 2012 MDOT Standard Specifications for Construction.

For protection of underground utilities and in conformance with Public Acts 174 of 2013, the contractor shall dial 1-800-482-7171 or 811 a minimum of three full working days, excluding Saturdays, Sundays, and holidays prior to beginning each excavation in areas where public utilities have not been previously located. Members will thus be routinely notified. This does not relieve the contractor of the responsibility of notifying utility owners who may not be a part of the MISS DIG alert system.

Public Utilities:

The following Public Utilities have facilities located within the Right-of-Way:

Telephone-FO

Acentek
5351 North M-37
PO Box 69
Mesick, MI 49668
231 885-3164
Contact: Kelly Stiner

Crude Oil

Lambda Energy Gathering
1515 Thomas Road
Kalkaska, MI 49646
231-590-1462
Contact: Ken Cavanaugh

Electric

Consumers Energy
300 Chestnut St
Cadillac, MI 49601
231-779-5536
Cell: 231-250-4505
Contact: Eric Marr

Gas (Transmission)

DTE Energy
1250 Michcon Lane SW
Kalkaska, MI 49646
231-258-3750
Contact: Karla Shawhan-Bonnee

The owners of existing service facilities that are within grading or structure limits will move them to locations designated by the Engineer or will remove them entirely from the highway Right-of-Way, when feasible. Owners of Public Utilities will not be required by the County to move additional poles or structures in order to facilitate the operation of construction equipment unless it is determined by the Engineer that such poles or structures constitute a hazard to the public or are extraordinarily dangerous to the Contractor's operations.

Wexford County Road Commission Itemized Bid Form

Bids Due: Monday, June 28, 2021 @ 3:00 PM

9 Road Crushing and Shaping

Item Number	Item Description	Estimated Quantity	Unit	Unit Price	Amount
2040050	Pavt, Rem	19	Syd		
2050011	Embankment, LM	100	Cyd		
3020001	Aggregate Base	5,558	Ton		
3050002	HMA Base Crushing and Shaping	124,850	Syd		
3070001	Approach, CI I	215	Ton		
3070021	Approach, CI II	159	Ton		
3070145	Shoulder, CI III, 3 inch	25,725	Syd		
3070200	Trenching	683	Sta		
5010005	HMA Surface, Rem	8	Syd		
8070095	Post, Mailbox	5	Ea		
8127051	Traffic Control	1	LSUM		
8210001	Monument Box	13	Ea		
8210010	Monument Preservation	13	Ea		
				Total Bid:	

Notes:

- Mobilization is included with the pay items and will not be paid for separately

Company Name: _____

Company Address: _____

Bidders Name & Title: _____

Bidders Signature: _____

Email Address: _____

Date: _____

The Board reserves the right to accept or reject any or all bids and to accept the bids it feels is in the best interest of the Wexford County Road Commission.

PLAN INDEX

SHEET NUMBER	SHEET DESCRIPTION
1	TITLE SHEET
2-3	TYPICAL CROSS SECTIONS
4	DETAIL SHEET
5	NOTE/LEGEND SHEET
6-10	PLAN SHEETS

WEXFORD COUNTY ROAD COMMISSION

PLANS OF PROPOSED IMPROVEMENTS TO

9 ROAD

SPRINGVILLE & WEXFORD TOWNSHIPS, WEXFORD COUNTY

TRAFFIC DATA

ADT (2020).....	990
% COMMERCIAL.....	3%
ADT (2040).....	1335
DESIGN SPEED.....	55 MPH

THE IMPROVEMENTS COVERED BY THESE PLANS SHALL BE DONE IN ACCORDANCE WITH THE MICHIGAN DEPARTMENT OF TRANSPORTATION 2012 STANDARD SPECIFICATIONS FOR CONSTRUCTION AND SUPPLEMENTAL SPECIFICATIONS AS AMENDED.

PLACING OF TEMPORARY TRAFFIC CONTROL ITEMS SHALL BE DONE IN ACCORDANCE WITH THE 2011 EDITION OF THE MICHIGAN MANUAL OF UNIFORM TRAFFIC CONTROL DEVICES, AS REVISED.

THE PROPOSED IMPROVEMENTS COVERED BY THESE PLANS ARE IN ACCORDANCE WITH SECTION C, RESURFACING, RESTORATION AND REHABILITATION (3R) OF THE MICHIGAN DEPARTMENT OF TRANSPORTATION LOCAL AGENCY PROGRAMS GUIDELINES FOR GEOMETRICS DATED JULY 24, 2017.

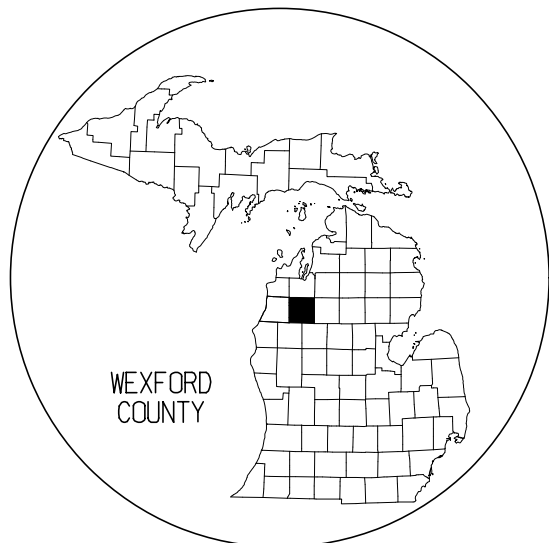

COUNTY KEY

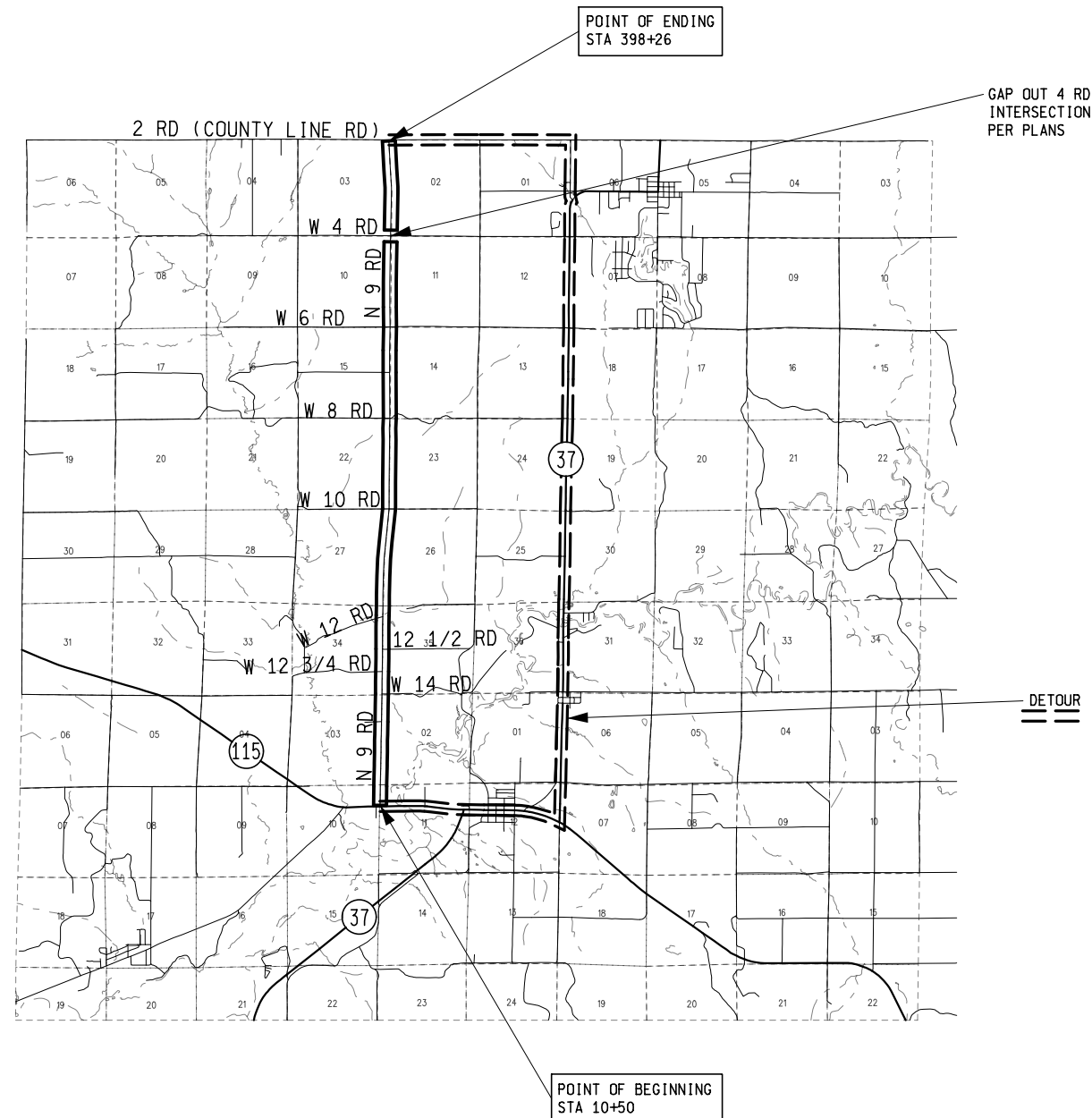

PROJECT LENGTH = 7.31 MILES

CONTRACT FOR:
TRENCHING, HMA BASE CRUSHING & SHAPING, AGGREGATE BASE AND AGGREGATE SHOULDERS.
(HMA PAVING BY OTHERS)

WEXFORD COUNTY ROAD COMMISSION APPROVALS

KARL F. HANSON, PE, WCRC MANAGER/ENGINEER

DATE

PREPARED UNDER SUPERVISION OF

PATRICK J. MIDDLETON, PE
REGISTERED PROFESSIONAL ENGINEER

45673
REGISTRATION NUMBER



3 WORKING DAYS
BEFORE YOU DIG
CALL MISS DIG
800-482-7171
OR 811

NOTES:

TRENCH 3.5' WIDTH (3" DEPTH) LT & RT. TRENCHED MATERIAL SHALL BE WINDROWED TO THE SHOULDER HINGE POINT.

ADD AGGREGATE BASE (21AA) TO A UNIFORM DEPTH OF 1" ON THE EXISTING HMA LANES (22' OR 24').

CRUSH THE EX PAVT, INCLUDING 2" OF THE UNDERLYING AGGREGATE. SPREAD AND SHAPE TO THE REQUIRED WIDTH.

BALANCE SURPLUS WINDROWED SHOULDER MATERIAL.

COORDINATE WITH WCRC FOR PLACEMENT OF HMA LEVELING COURSE (BY OTHERS)

BRING UP OUTSIDE SHOULDERS WITH CL III SHOULDER MATERIAL.

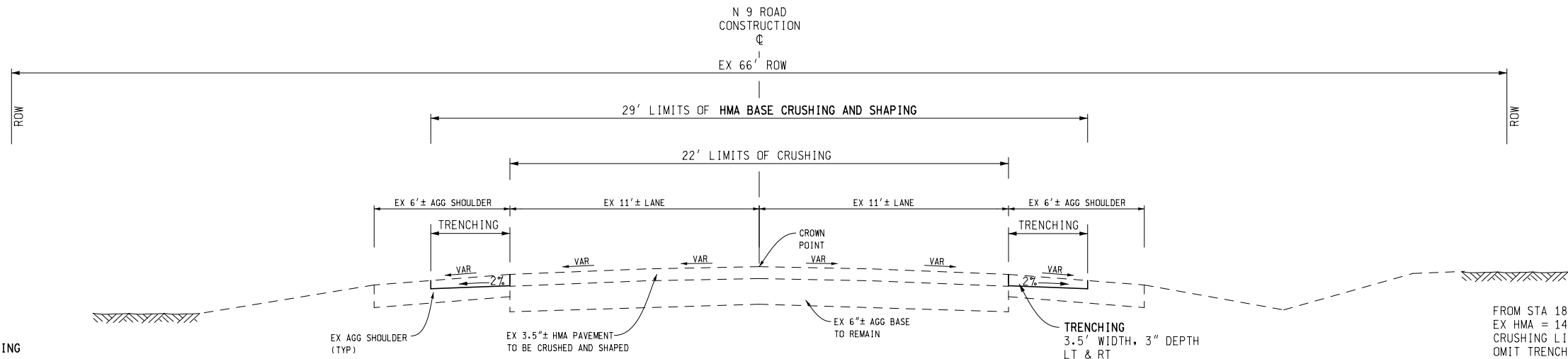

EXISTING NORMAL CROWN SECTION

SECTION APPLIES:
 POB STA 10+50 TO STA 180+58
 STA 186+15 TO STA 341+41
 STA 343+49 TO STA 367+08
 STA 371+33 TO POE STA 398+26

FROM STA 181+50 TO STA 185+65 LT
 EX HMA = 14' LT
 CRUSHING LIMITS = 14' LT
 OMIT TRENCHING LT
 HMA BASE CRUSHING AND SHAPING = 14' LT

FROM STA 21+85 TO STA 33+50 &
 FROM STA 108+50 TO STA 134+09 &
 FROM STA 247+50 TO STA 253+50
 EX HMA = 28'
 CRUSHING LIMITS = 28'
 OMIT TRENCHING
 HMA BASE CRUSHING AND SHAPING = 28'

NORTH OF 4 ROAD
 FROM STA 343+39 TO POE STA 398+26
 EX HMA = 24' (11' LANES AND 1' SHOULDER LT & RT)
 CRUSHING LIMITS = 24'
 TRENCHING WIDTH = 2.5'
 HMA BASE CRUSHING AND SHAPING = 29'

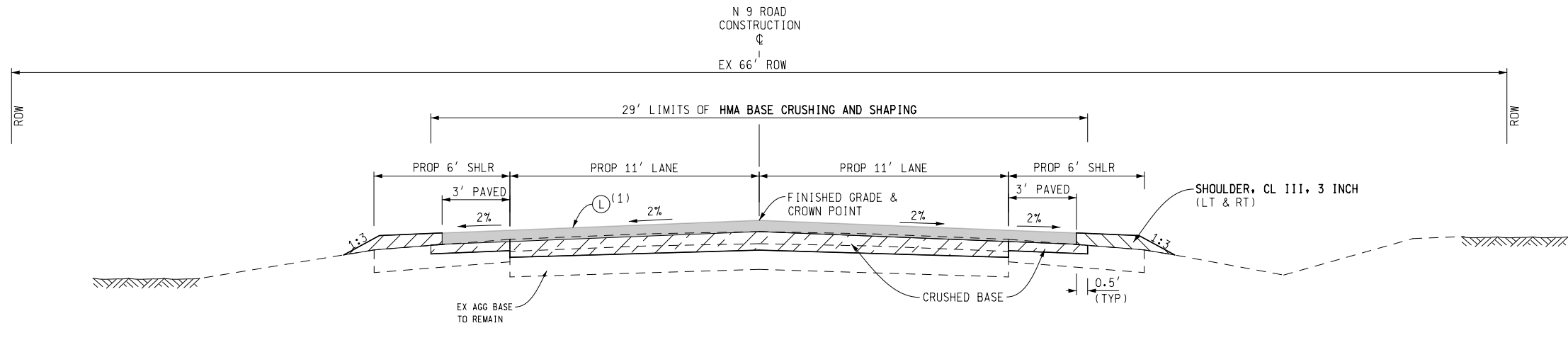

PROPOSED NORMAL CROWN CRUSH & SHAPE SECTION

SECTION APPLIES:
 POB STA 10+50 TO STA 180+58
 STA 186+15 TO STA 341+51
 STA 343+39 TO STA 367+08
 STA 371+33 TO POE STA 398+26

FINISHED GRADE IS ANTICIPATED TO BE 3" ABOVE EXISTING HMA CENTERLINE ELEVATIONS. (1)

GAP OUT 4 RD INTERSECTION FROM STA 341+51 TO STA 343+39

(1) HMA PAVING BY OTHERS.

HMA APPLICATION ESTIMATE FOR INFORMATION ONLY - HMA PAVING BY OTHERS

IDENT NO.	ITEM	RATE PER SYD	PERFORMANCE GRADE	REMARKS
(L)	HMA, 4E1	220#	PG 58-28	LEVELING COURSE
(A1)	HMA, 4E1	220#	PG 58-28	APPROACH RDS
(A2)	HMA, 4E1	VAR	PG 58-28	DRIVES
	* BOND COAT	0.05-0.15 GAL/SYD		

* FOR INFORMATION ONLY

SEPARATE PROJECTS WILL PLACE HMA, 4E1 AND CLASS II AGGREGATE SHOULDERS. SEE SPECIFICATIONS FOR COORDINATION REQUIREMENTS.



3 WORKING DAYS BEFORE YOU DIG
 CALL MISS DIG
 800-482-7171 OR 811

WEXFORD
 County Road Commission

KPM ENGINEERING

TYPICAL CROSS SECTIONS

DATE	TOWNSHIP	JOB NO.	SHEET NO.
6/9/2021	SPRINGVILLE & WEXFORD		2

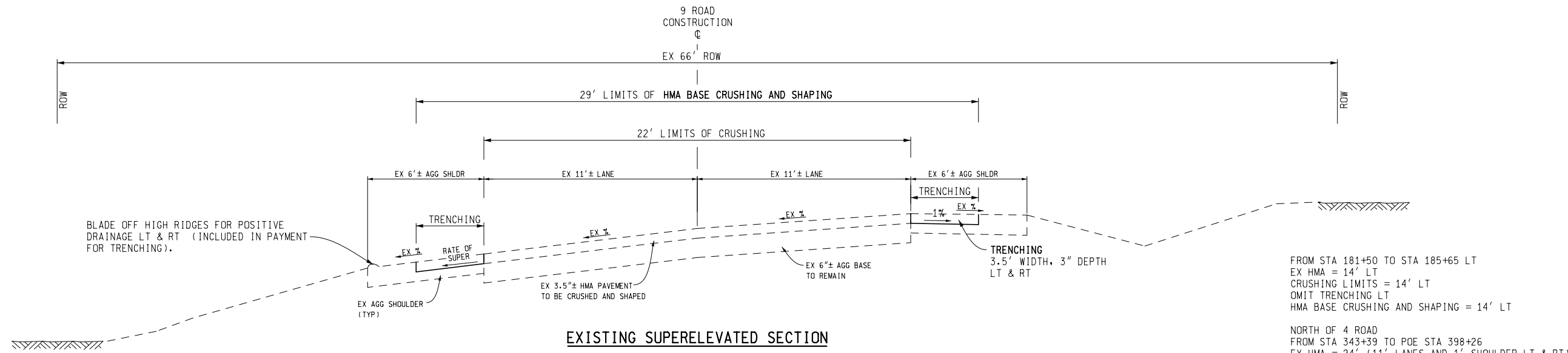

EXISTING SUPERELEVATED SECTION

SECTION APPLIES:
 STA 180+58 TO STA 186+15 (EX SUPER = NORMAL CROWN)
 STA 367+08 TO STA 371+33 (EX SUPER = 2.7% LT)

FROM STA 181+50 TO STA 185+65 LT
 EX HMA = 14' LT
 CRUSHING LIMITS = 14' LT
 OMIT TRENCHING LT
 HMA BASE CRUSHING AND SHAPING = 14' LT

NORTH OF 4 ROAD
 FROM STA 343+39 TO POE STA 398+26
 EX HMA = 24' (11' LANES AND 1' SHOULDER LT & RT)
 CRUSHING LIMITS = 24'
 TRENCHING WIDTH = 2.5'
 HMA BASE CRUSHING AND SHAPING = 29'

- NOTES:**
- TRENCH 3.5' WIDTH (3" DEPTH) LT & RT. TRENCHED MATERIAL SHALL BE WINDROWED TO THE SHOULDER HINGE POINT.
 - ADD AGGREGATE BASE (21AA) TO A UNIFORM DEPTH OF 1" ON THE EXISTING HMA LANES (22' OR 24').(2)
 - CRUSH THE EX PAVT, INCLUDING 2" OF THE UNDERLYING AGGREGATE. SPREAD AND SHAPE TO THE REQUIRED WIDTH.
 - BALANCE SURPLUS WINDROWED SHOULDER MATERIAL.
 - COORDINATE WITH WCRC FOR PLACEMENT OF HMA LEVELING COURSE (BY OTHERS)
 - BRING UP OUTSIDE SHOULDERS WITH CL III SHOULDER MATERIAL.
 - (2) FOR SUPERELEVATION MODIFICATIONS, ADD ADDITIONAL AGGREGATE BASE AS DIRECTED BY THE ENGINEER.

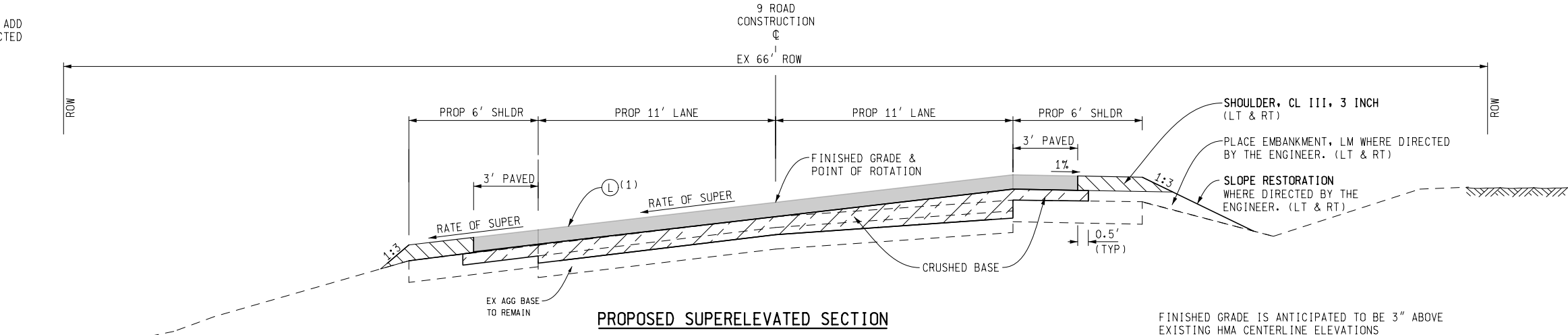

PROPOSED SUPERELEVATED SECTION

SUPERELEVATION TRANSITION TO APPLY (INCLUDES CROWN RUNOUT)
 STA 180+58 TO STA 182+02
 STA 184+70 TO STA 186+15
 STA 367+08 TO STA 368+70
 STA 369+71 TO STA 371+33

FULL SUPERELEVATION TO APPLY
 STA 182+02 TO STA 184+70 (3.4% LT)
 STA 368+70 TO STA 369+71 (4.5% LT)

FINISHED GRADE IS ANTICIPATED TO BE 3" ABOVE EXISTING HMA CENTERLINE ELEVATIONS
 (1) HMA PAVING BY OTHERS.

SEPARATE PROJECTS WILL PLACE HMA, 4E1 AND CLASS II AGGREGATE SHOULDERS. SEE SPECIFICATIONS FOR COORDINATION REQUIREMENTS.



3 WORKING DAYS BEFORE YOU DIG
 CALL MISS DIG
 800-482-7171 OR 811

WEXFORD
 County Road Commission

KPM ENGINEERING

TYPICAL CROSS SECTIONS			
DATE	TOWNSHIP	JOB NO.	SHEET NO.
6/9/2021	SPRINGVILLE & WEXFORD		3

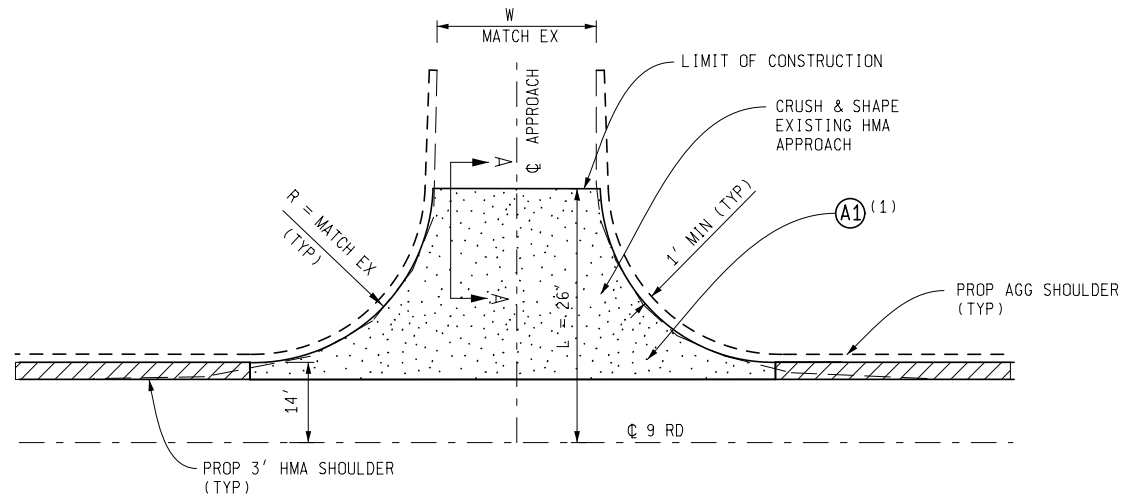

APPROACH TREATMENT TYPE I (EX HMA)

TO APPLY:
SADIE LANE (LT) WIDTH (W)
18'

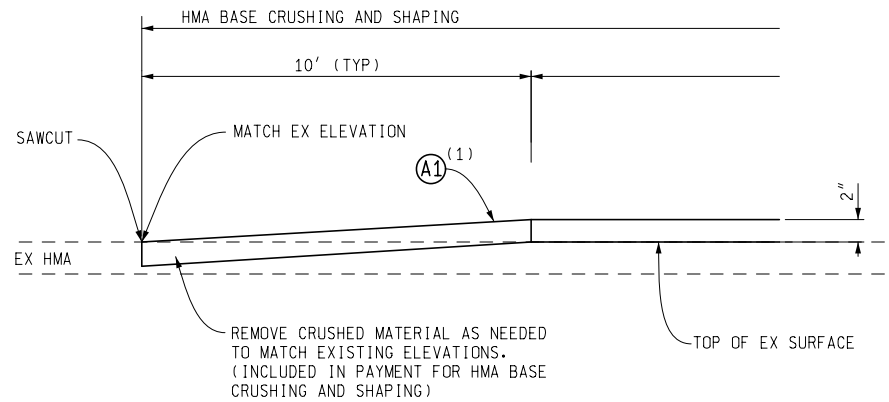

SECTION A-A

REMOVE CRUSHED MATERIAL AS NEEDED TO MATCH EXISTING ELEVATIONS. (INCLUDED IN PAYMENT FOR HMA BASE CRUSHING AND SHAPING)

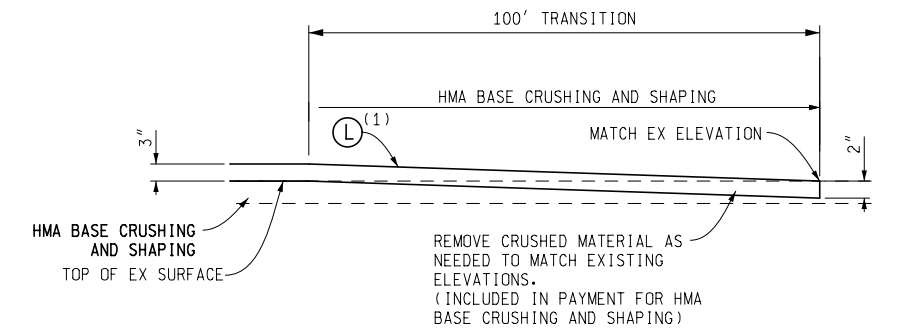

BUTT JOINT DETAIL

TO APPLY:
POB STA 10+50
POE STA 398+26
BOTH SIDES 4 RD GAPOUT

(1) HMA PAVING BY OTHERS.

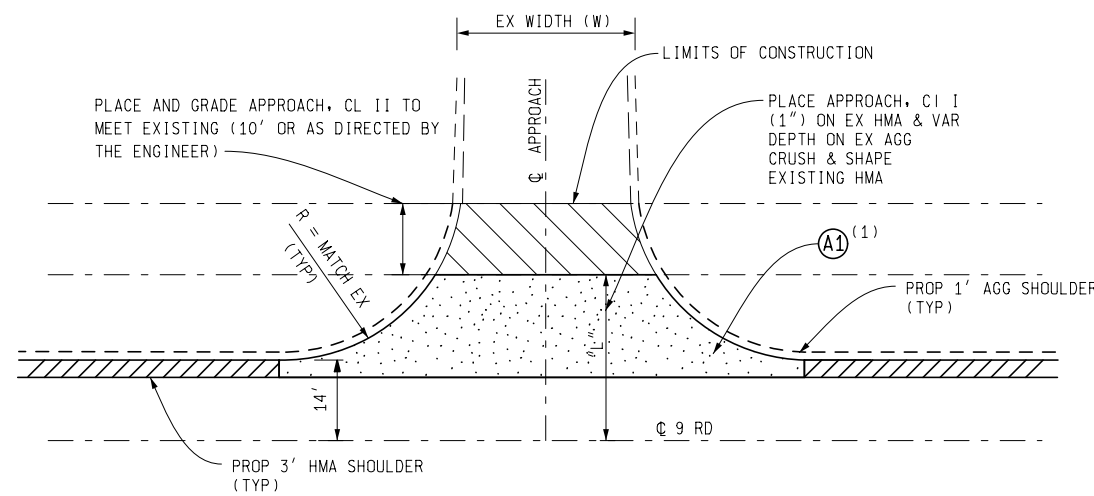

APPROACH TREATMENT TYPE II (EX AGG W/HMA APRON)

TO APPLY:

"L"	
100'	14 RD RT
170'	12 3/4 RD LT
21'	12 1/2 RD RT
50'	12 RD LT
21'	CREST LANE LT
75'	10 RD LT
75'	10 RD RT
75'	8 RD LT
150'	8 RD RT
75'	6 1/2 RD LT
75'	6 RD LT
75'	6 RD RT

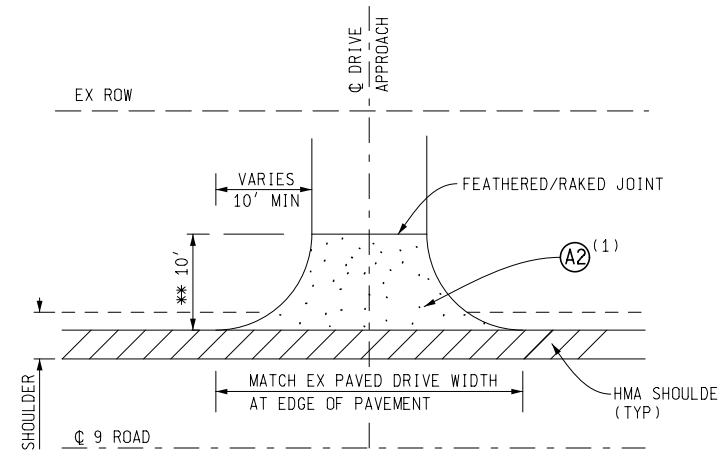

HMA PAVED DRIVEWAY DETAIL

EX & PROP HMA SURFACE

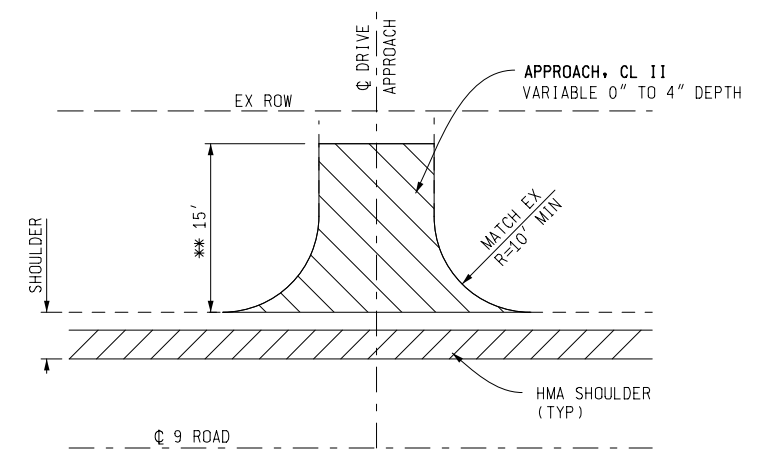

UN-PAVED DRIVEWAY DETAIL

EX & PROP GRAVEL SURFACE

**OR AS DIRECTED BY THE ENGINEER



3 WORKING DAYS BEFORE YOU DIG
CALL MISS DIG
800-482-7171
OR 811

WEXFORD
County Road Commission

KPM ENGINEERING

DETAIL SHEET			
DATE	TOWNSHIP	JOB NO.	SHEET NO.
6/9/2021	SPRINGVILLE & WEXFORD		4

MISCELLANEOUS SYMBOLS

- ☆ PINE TREE
- ☼ TREE
- ⌒ STUMP
- ☼ SWAMP
- ⊗ T.H.# TEST HOLE NO.
- ◁ EXISTING CULVERT END SECTION
- ◄ PROPOSED CULVERT END SECTION
- ⊙ SECTION CORNER
- ⊗ QUARTER QUARTER CORNER
- ⊙ QUARTER CORNER
- ⊙ HALF QUARTER CORNER
- T SIGN
- TT SIGN2
- ⊗ RIPRAP
- ⊙ EXISTING PROPERTY CORNER

UTILITIES SYMBOLS

- POWER POLE
- GUY POLE
- TELEPHONE POLE
- Ⓣ TELEPHONE MANHOLE
- ⊕ TELEPHONE PEDESTAL
- Ⓜ GAS LINE MARKER
- Ⓜ GAS VALVE
- Ⓜ MAIL BOX
- Ⓜ DEADMAN FOR GUYWIRE

HAZARDOUS OR
FLAMMABLE MATERIAL

CAUTION - CRITICAL
UNDERGROUND UTILITY

TOPO LIFESTYLES

- ☼ TREE LINE
- x—x— EXISTING FENCE
- · · · — EXISTING DRAINAGE COURSE
EDGE OF WATER
- · · · — PROPOSED DRAINAGE COURSE
EDGE OF WATER
- PROP 36" — PROPOSED CULVERT/SEWER
- EX 12" CMP — EXISTING CULVERT/SEWER
- ⊗ ⊗ ⊗ PROPOSED CRUSH & SHAPE
- ▒ PROPOSED HMA APPROACH
- ▒ PROP CL II APPROACH

UNDERGROUND UTILITY LIFESTYLES

- ELEC — ELECTRICAL LINE
- 24"GAS — GAS LINE
- 12"OIL — OIL LINE
- TELE — TELEPHONE LINE
- 36"WM — WATER LINE
- CTV — CABLE TV
- FO — FIBER OPTICS

ABOVE GROUND UTILITY LIFESTYLES

- POWER TRANSMISSION
LINE

GENERAL PLAN NOTES

UNDERGROUND UTILITIES / MISS DIG

FOR PROTECTION OF UNDERGROUND UTILITIES AND IN CONFORMANCE WITH PUBLIC ACT 174 OF 2013, THE CONTRACTOR SHALL DIAL 1-800-482-7171 OR 811 A MINIMUM OF THREE FULL WORKING DAYS, EXCLUDING SATURDAYS, SUNDAYS, AND HOLIDAYS PRIOR TO BEGINNING EACH EXCAVATION IN AREAS WHERE PUBLIC UTILITIES HAVE NOT BEEN PREVIOUSLY LOCATED. MEMBERS WILL THUS BE ROUTINELY NOTIFIED. THIS DOES NOT RELIEVE THE CONTRACTOR OF THE RESPONSIBILITY OF NOTIFYING UTILITY OWNERS WHO MAY NOT BE A PART OF THE "MISS DIG" ALERT SYSTEM.

SOIL EROSION MEASURES

APPROPRIATE SOIL EROSION AND SEDIMENTATION CONTROL MEASURES SHALL BE IN PLACE PRIOR TO EARTH-DISTURBING ACTIVITIES. PLACE TURF ESTABLISHMENT ITEMS AS SOON AS POSSIBLE ON POTENTIAL ERODIBLE SLOPES AS DIRECTED BY THE ENGINEER. CRITICAL DITCH GRADES SHALL BE PROTECTED WITH EITHER SOD OR SEED/MULCH OR MULCH BLANKET AS DIRECTED BY THE ENGINEER.

ADJUSTING MONUMENT BOXES

ALL GOVERNMENT CORNERS ON THIS PROJECT SHALL BE PRESERVED, WHETHER SHOWN OR NOT. IT MAY BE NECESSARY TO PLACE OR ADJUST MONUMENT BOXES, AS REQUIRED.

AGGREGATE BASE

AGGREGATE BASE USED ON THIS PROJECT SHALL BE AGGREGATE 21AA.

TRENCHING & HMA BASE CRUSHING AND SHAPING

PRIOR TO BEGINNING THIS WORK THE COUNTY WILL ROTOTILL THE SHOULDERS TO PROVIDE AN EASIER MATERIAL TO WORK WITH. TRENCHED MATERIAL SHALL BE WINDOWED TO THE SHOULDER HINGE POINT. TRENCHED MATERIAL SHALL NOT BE USED UNDERNEATH THE PAVEMENT SECTION. THE CONTRACTOR SHALL MAKE EVERY EFFORT TO USE EXCESS CRUSHED MATERIAL TO CONSTRUCT THE PROPOSED CROSS SECTION. WHERE SURPLUS CRUSHED MATERIAL IS USED FOR AGGREGATE SHOULDERS, IT SHALL BE PAID FOR AS SHOULDER, CL III, 3 INCH. COST FOR LOADING, HAULING, PLACING AND COMPACTING OTHER CRUSHED MATERIAL THROUGHOUT THE PROJECT LIMITS WILL BE INCLUDED IN THE ITEM OF HMA BASE CRUSHING AND SHAPING AND WILL NOT BE PAID FOR SEPARATELY. DISPOSAL OF SURPLUS OR UNSUITABLE EXCESS CRUSHED MATERIAL WILL NOT BE PAID FOR SEPARATELY BUT WILL BE INCLUDED IN THE ITEM OF HMA BASE CRUSHING AND SHAPING. (THE WCRC PIT LOCATED IN SECTION 34, WEXFORD TOWNSHIP, JUST WEST OF 9 ROAD MAY BE USED FOR DISPOSAL).

SAWCUTTING

SAWCUT AT ALL LIMITS OF CONSTRUCTION INCLUDING DRIVEWAYS. PAYMENT FOR SAWCUTTING REQUIRED THROUGHOUT THE PROJECT SHALL BE INCLUDED IN OTHER ITEMS.

SOIL BORINGS AND PAVEMENT CORES

THE SOIL BORING LOGS AND PAVEMENT CORES REPRESENT POINT INFORMATION. NO INFERENCE SHOULD BE MADE THAT SUBSURFACE OR PAVEMENT CONDITIONS ARE THE SAME AT OTHER LOCATIONS.

SLOPE RESTORATION

THE WCRC WILL PERFORM SLOPE RESTORATION IN AREAS WHERE THE ENGINEER REQUIRES PLACEMENT OF EMBANKMENT.

THE CONTRACTOR IS RESPONSIBLE FOR RESTORING STAGING AND/OR STOCKPILING AREAS AS WELL AS ANY ADDITIONAL AREAS DISTURBED NOT AS A RESULT OF REQUIRED CONTRACT OPERATIONS.



3 WORKING DAYS
BEFORE YOU DIG
CALL MISS DIG
800-482-7171
OR 811

UTILITIES

THE EXISTING UTILITIES LISTED BELOW AND SHOWN ON THESE PLANS REPRESENT THE BEST INFORMATION AVAILABLE. THIS INFORMATION DOES NOT RELIEVE THE CONTRACTOR OF THE RESPONSIBILITY TO BE SATISFIED AS TO ITS ACCURACY AND THE LOCATION OF EXISTING UTILITIES.

UTILITY NAME UTILITY TYPE

- CONSUMERS ENERGY ELECTRIC
300 CHESTNUT ST
CADILLAC, MI 49601
CONTACT: ERIC MARR
231-779-5536
- ACCEN TEK TELEPHONE-FO
5351 NORTH M-37
PO BOX 69
MESICK, MI 49668
CONTACT: KELLY STINER
(231) 885-3164
- LAMBDA ENERGY GATHERING CRUDE OIL
1515 THOMAS ROAD
KALKASKA, MI 49646
CONTACT: KEN CAVANAUGH
(231) 590-1462 CELL
- DTE ENERGY GAS (TRANSMISSION)
1250 MICHCON LANE SW
KALKASKA, MI 49646
CONTACT: KARLA SHAWHAN-BONNEE
(231) 258-3750
- JAGUAR ENERGY LLC SOUTH GAS
SAUNDERS RD
KALKASKA, MI 49646
CONTACT: CRAIG MILLER
(231) 590-4053

EMBANKMENT

THE WCRC PIT LOCATED IN SECTION 34, WEXFORD TOWNSHIP, JUST WEST OF 9 ROAD IS AVAILABLE FOR OBTAINING EMBANKMENT.

MISCELLANEOUS ESTIMATES

THE FOLLOWING ITEMS OF WORK SHALL BE DONE AS THEY APPLY THROUGHOUT THE PROJECT AS DIRECTED BY THE ENGINEER. THESE ITEMS ARE NOT DETAILED OR INCLUDED ON THE PLAN AND PROFILE SHEETS:

MISCELLANEOUS ITEMS	
5 Ea 100 Cyd	Post, Mailbox Embankment, LM

THE FOLLOWING ITEMS OF WORK ARE ESTIMATED FOR THE ENTIRE PROJECT FOR MAINTAINING TRAFFIC WHERE DESIGNATED BY THE ENGINEER.

MISCELLANEOUS ITEMS	
1 LSUM	Traf Control

NOTES APPLYING TO ROAD STANDARD PLANS

WHERE THE FOLLOWING ITEMS ARE CALLED FOR ON THE PLANS, THEY ARE TO BE CONSTRUCTED ACCORDING TO THE STANDARD PLAN GIVEN BELOW OPPOSITE EACH ITEM UNLESS OTHERWISE INDICATED.

- R-11-E MONUMENT BOXES

NOTES APPLYING TO TRAFFIC AND SAFETY STANDARD PLANS

WHERE THE FOLLOWING ITEMS ARE CALLED FOR ON THE PLANS, THEY ARE TO BE CONSTRUCTED ACCORDING TO THE STANDARD PLAN GIVEN BELOW OPPOSITE EACH ITEM UNLESS OTHERWISE INDICATED.

- * WZD-100-A GROUND DRIVEN SIGN SUPPORTS FOR TEMP SIGNS
- * WZD-125-E TEMPORARY TRAFFIC CONTROL DEVICES
- PAVE-905-E LONGITUDINAL LINE TYPES AND PLACEMENT

* DENOTES SPECIAL DETAIL

9 RD NOTE / LEGEND SHEET

DATE	TOWNSHIP	JOB NO.	SHEET NO.
6/9/2021	SPRINGVILLE & WEXFORD		5

WEXFORD
County Road Commission



M-115
EX 30' HMA
C = +00

N 9 RD
POINT OF BEGINNING
STA 10+50

SECTION 10
T23N R12W
SPRINGVILLE TWP

SEC CORNER
PRESERVE &
NEW MON BOX
Monument Preservation
Monument Box

SECTION 3
T23N R12W
SPRINGVILLE TWP

SECTION 11
T23N R12W
SPRINGVILLE TWP

SECTION 2
T23N R12W
SPRINGVILLE TWP

FOR DRIVEWAYS THROUGH-OUT PROJECT

8 Syd	HMA Surface, Rem (FOR CONC DR 115+50 LT)
19 Syd	Pavt. Rem (FOR CONC DR 115+50 LT)
120 Ton	Approach, CI II

PAVT CORE #01
STA 39+50, 9' RT
3" HMA
5" AGG (GOOD)

1/4 CORNER
PRESERVE &
NEW MON BOX
Monument Preservation
Monument Box

SECTION 3
T23N R12W
SPRINGVILLE TWP

SADIE LANE - CONSTRUCT TYPE I APPR, L= 26' LT
82 Syd HMA Base Crushing and Shaping

SADIE LANE
EX 18' HMA

SECTION 2
T23N R12W
SPRINGVILLE TWP

SECTION 34
T24N R12W
WEXFORD TWP

12 & 3/4 RD
EX 22' AGG

12 3/4 RD - CONSTRUCT TYPE II APPR, L= 170' LT
112 Syd HMA Base Crushing and Shaping
35 Ton Approach, CI I
3 Ton Approach, CI II

SEC CORNER
PRESERVE &
NEW MON BOX
Monument Preservation
Monument Box

SECTION 3
T23N R12W
SPRINGVILLE TWP

SECTION 35
T24N R12W
WEXFORD TWP

14 RD - CONSTRUCT TYPE II APPR, L= 100' RT
123 Syd HMA Base Crushing and Shaping
21 Ton Approach, CI I
3 Ton Approach, CI II

14 RD
EX 30' AGG

CONSTRUCTION QUANTITIES THIS SHEET (POB STA 10+50 TO STA 90+00)
1094 Ton Aggregate Base (1" ON LANES)
25,488 Syd HMA Base Crushing and Shaping
136 Sta Trenching
5300 Syd Shoulder, CI III, 3 inch



3 WORKING DAYS
BEFORE YOU DIG
CALL MISS DIG
800-482-7171
OR 811

WEXFORD
County Road Commission



9 RD - POB STA 10+50 TO STA 90+00

DATE	TOWNSHIP	JOB NO.	SHEET NO.
6/9/2021	SPRINGVILLE & WEXFORD		6

2:43:35 PM
6/9/2021

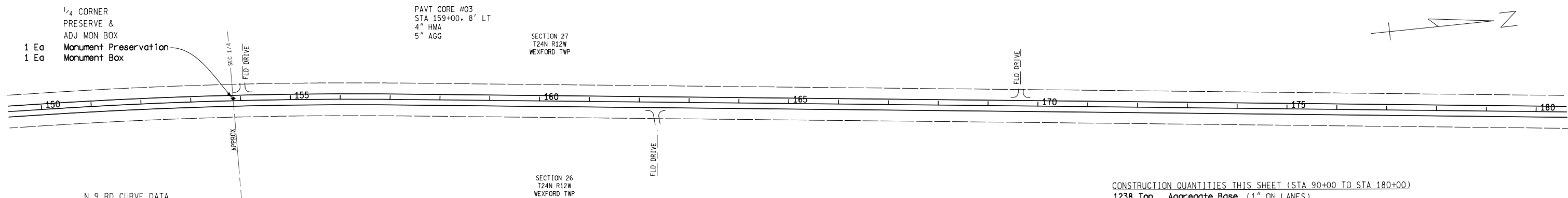
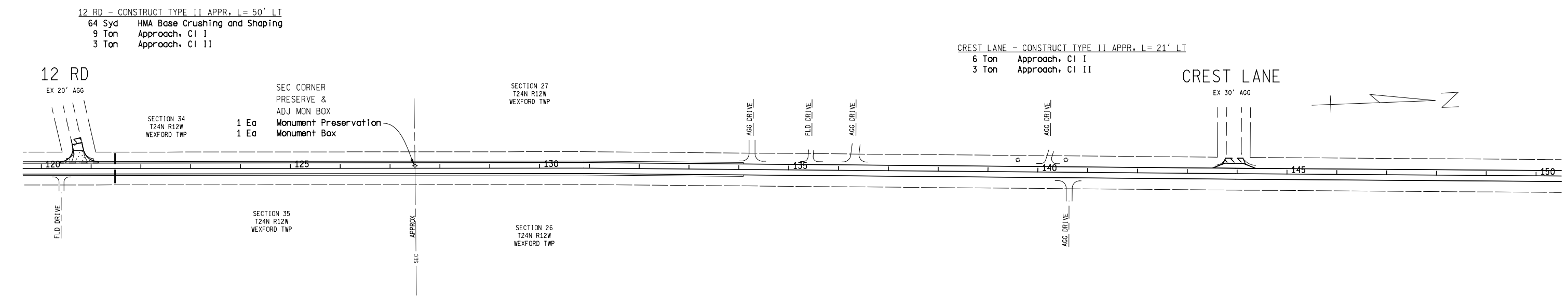
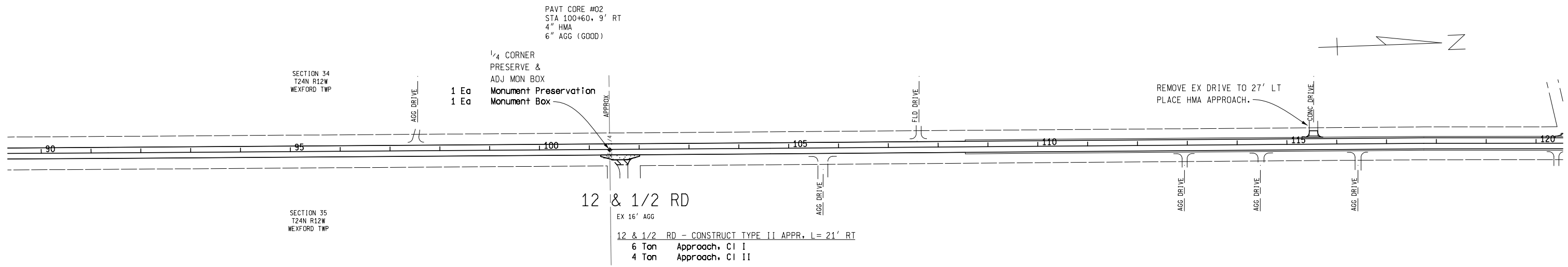

3 WORKING DAYS
BEFORE YOU DIG
CALL MISS DIG
800-482-7171
OR 811

WEXFORD
County Road Commission

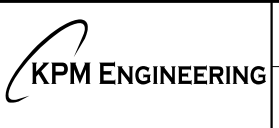

9 RD - STA 90+00 TO STA 180+00			
DATE	TOWNSHIP	JOB NO.	SHEET NO.
6/9/2021	SPRINGVILLE & WEXFORD		7

6/9/2021 2:45:08 PM

CURVE 9 RD C
 $\Delta = 5^{\circ} 16' 14''$ (LT)
 $D = 1^{\circ} 36' 10''$
 $T = 164.53'$
 $L = 328.82'$
 $R = 3,574.65'$
 $E = 3.78'$
 $PC = 181+72.07$
 $PI = 183+36.60$
 $PT = 185+00.89$
 $EX = \text{NORMAL CROWN}$
 $\text{PROP SUPER} = 3.4\% \text{ LT}$

10 RD - CONSTRUCT TYPE II APPR, L=75' LT
 74 Syd HMA Base Crushing and Shaping
 20 Ton Approach, CI I
 4 Ton Approach, CI II

10 RD - CONSTRUCT TYPE II APPR, L=75' RT
 120 Syd HMA Base Crushing and Shaping
 20 Ton Approach, CI I
 4 Ton Approach, CI II

8 RD - CONSTRUCT TYPE II APPR, L=75' LT
 114 Syd HMA Base Crushing and Shaping
 20 Ton Approach, CI I
 3 Ton Approach, CI II

8 RD - CONSTRUCT TYPE II APPR, L=150' RT
 76 Syd HMA Base Crushing and Shaping
 26 Ton Approach, CI I
 3 Ton Approach, CI II

6 & 1/2 RD - CONSTRUCT TYPE II APPR, L=75' LT
 76 Syd HMA Base Crushing and Shaping
 18 Ton Approach, CI I
 3 Ton Approach, CI II

CONSTRUCTION QUANTITIES THIS SHEET (STA 180+00 TO STA 270+00)
 142 Ton Aggregate Base (SUPERELEVATION MODS)
 1238 Ton Aggregate Base (1" ON LANES)
 28,911 Syd HMA Base Crushing and Shaping
 164 Sta Trenching
 6000 Syd Shoulder, CI III, 3 inch



3 WORKING DAYS
 BEFORE YOU DIG
 CALL MISS DIG
 800-482-7171
 OR 811

WEXFORD
 County Road Commission

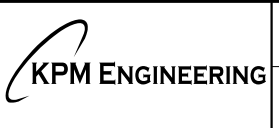

9 RD - STA 180+00 TO STA 270+00		DATE	TOWNSHIP	JOB NO.	SHEET NO.
		6/9/2021	SPRINGVILLE & WEXFORD		8

6/9/2021 2:43:21 PM

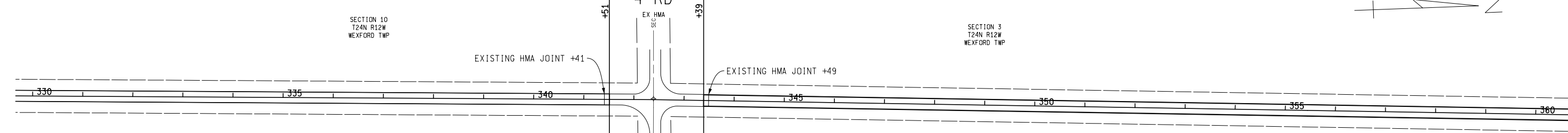
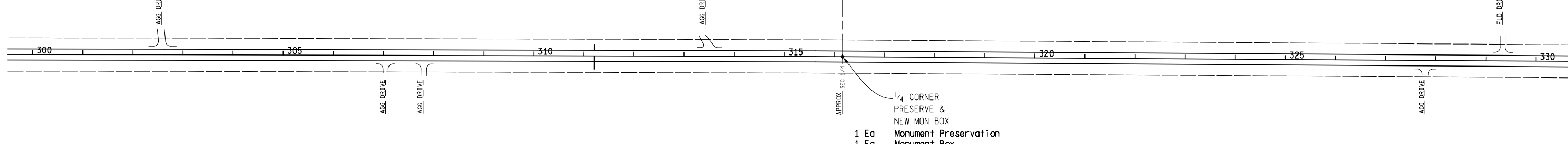
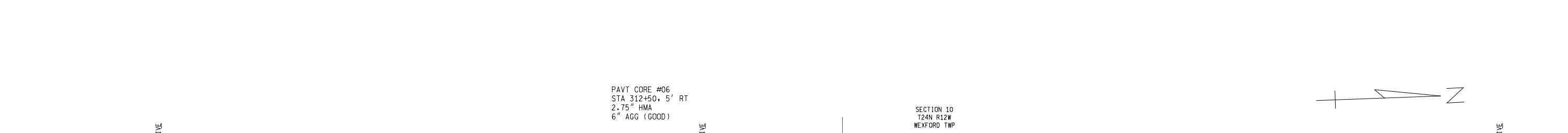
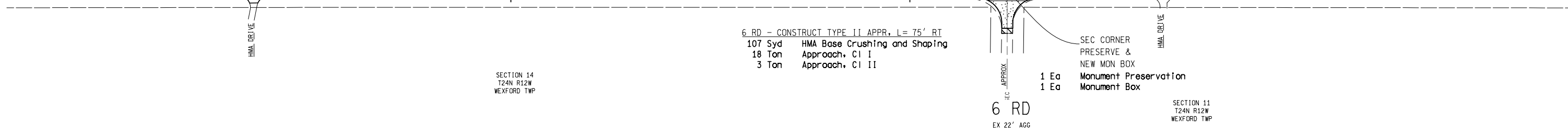
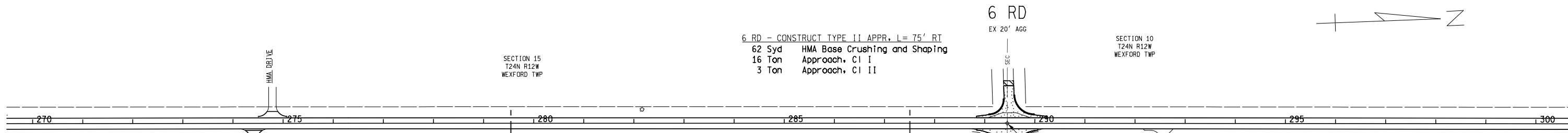

CONSTRUCTION QUANTITIES THIS SHEET (STA 270+00 TO STA 360+00)

1234 Ton	Aggregate Base (1" ON LANES)
28,396 Syd	HMA Base Crushing and Shaping
178 Sta	Trenching
5875 Syd	Shoulder, CI III, 3 inch

811
3 WORKING DAYS
BEFORE YOU DIG
CALL MISS DIG
800-482-7171
OR 811

WEXFORD
County Road Commission

KPM ENGINEERING

9 RD - STA 270+00 TO STA 360+00			
DATE	TOWNSHIP	JOB NO.	SHEET NO.
6/9/2021	SPRINGVILLE & WEXFORD		9

6/9/2021 2:43:25 PM

CURVE 9 RD
 $\Delta = 4^{\circ} 19' 40''$ (LT)
 $D = 2^{\circ} 27' 51''$
 $T = 87.85'$
 $L = 175.62'$
 $R = 2,325.06'$
 $E = 1.66'$
 $PC = 368+32.52$
 $PI = 369+20.38$
 $PT = 370+08.15$
 $EX SUPER = 2.7\% LT$
 $PR SUPER = 4.5\% LT$

PAVT CORE #07
 STA 368+00, 6' LT
 3" HMA
 6" AGG (GOOD)

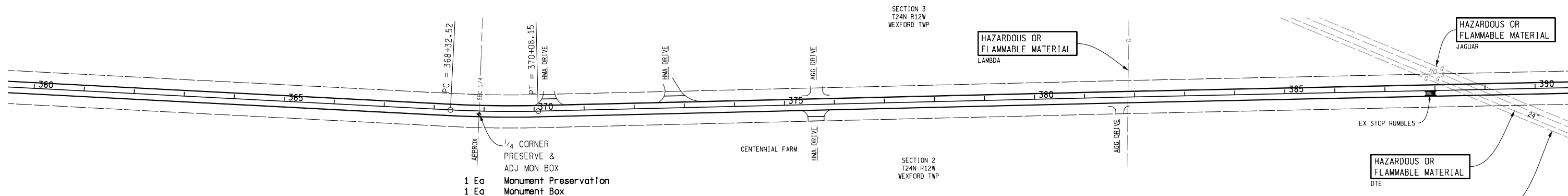
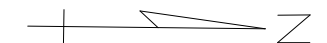

1 Ea Monument Preservation
 1 Ea Monument Box

N 9 RD
 POINT OF ENDING
 STA 398+26

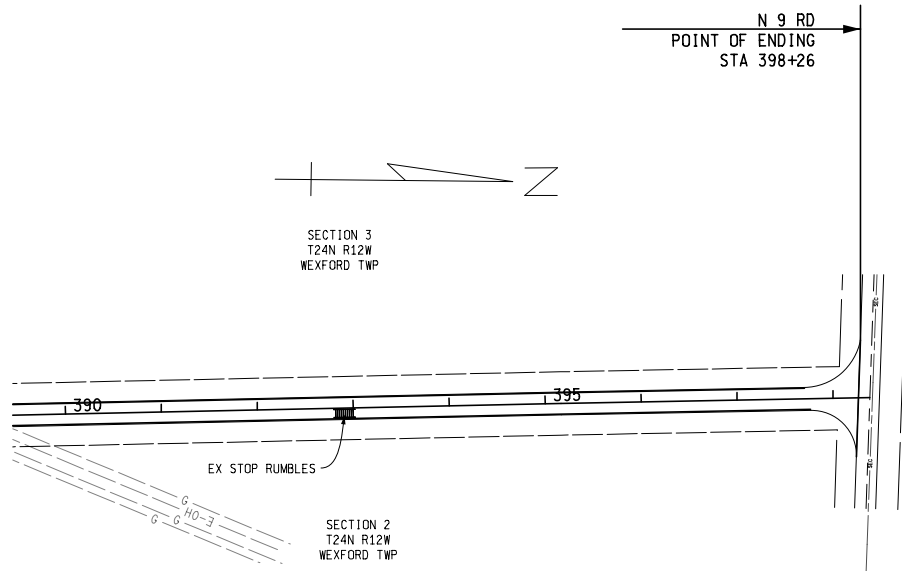
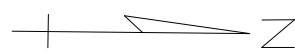

2 RD
 (COUNTY LINE RD)
 EX HMA
 @ = +38

CONSTRUCTION QUANTITIES THIS SHEET (STA 360+00 TO POE STA 398+26)

38 Ton	Aggregate Base (SUPERELEVATION MODS)
574 Ton	Aggregate Base (1" ON LANES)
12,329 Syd	HMA Base Crushing and Shaping
77 Sta	Trenching
2551 Syd	Shoulder, CI III, 3 inch

811
 3 WORKING DAYS
 BEFORE YOU DIG
 CALL MISS DIG
 800-482-7171
 OR 811

WEXFORD
 County Road Commission

KPM ENGINEERING

9 RD - STA 360+00 TO POE STA 398+26			
DATE	TOWNSHIP	JOB NO.	SHEET NO.
6/9/2021	SPRINGVILLE & WEXFORD		10

2:43:28 PM 6/9/2021